



97- 06 TJ REAR SHOCK BRACKET

Thank you for choosing Rough Country for your Jeep off road needs.

Please read all the instructions before beginning the installation.

PRODUCT USE INFORMATION

We will be happy to answer any questions regarding our products by calling us @ 800-222-7023. Rough Country will not be responsible for any product that is altered.

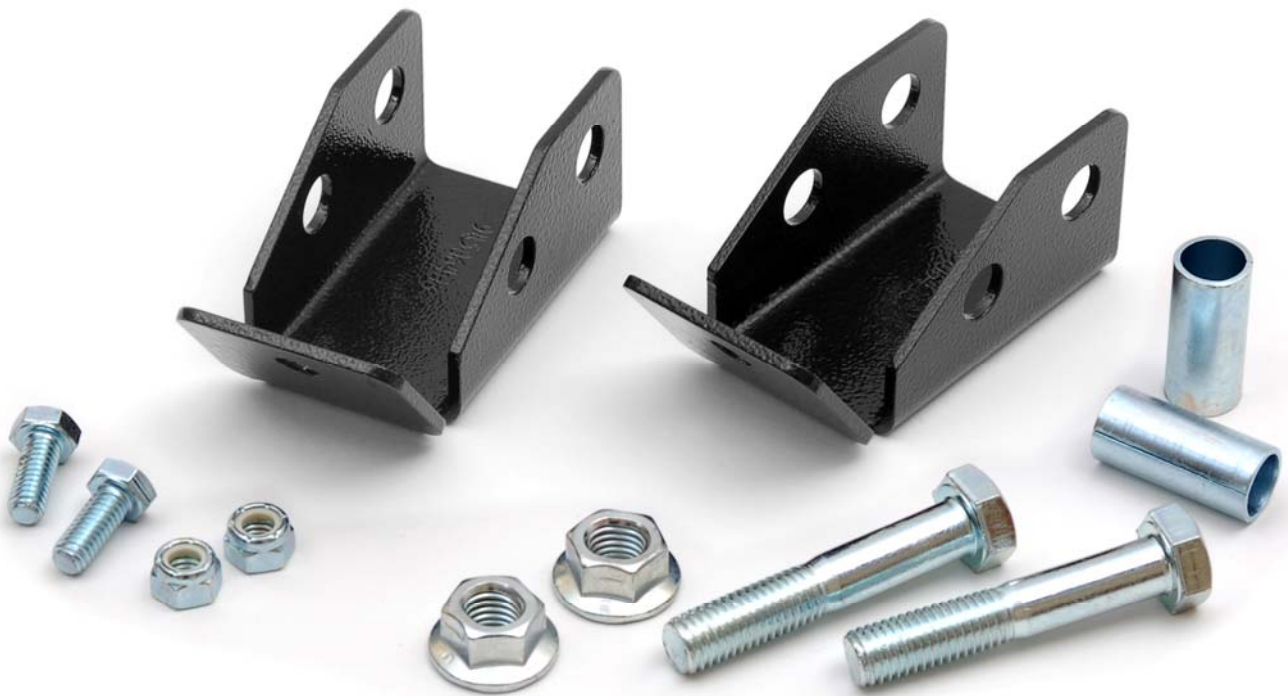

KIT CONTENTS

2-REAR SHOCK BRACKET
1-POLY BAG CONTAINING:
2-12MM X 65MM BOLTS
2-12MM FLANGE LOCKNUTS
2-5/16" X 3/4" BOLTS
2-5/16" LOCKNUTS
2-CRUSH SLEEVES
4-FLAT WASHERS

TOOLS NEEDED

13mm Socket / Wrench
15mm Socket / Wrench
18mm Socket / Wrench

INSTALLATION INSTRUCTIONS

1. After the shock has been removed from the lower mount, install the lower shock bracket as shown in **Photo 1** with the supplied 12mm x 65mm bolts, flange locknuts with supplied crush sleeve. Do not tighten at this time.
2. Install the 5/16" x 3/4" bolts, washers & nuts as shown in **Photo 2**. Tighten using a 13mm socket / wrench.

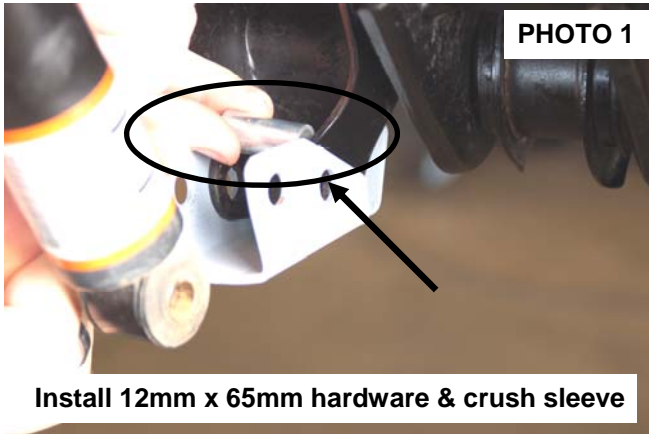

3. Tighten the 12mm bolts using a 18mm wrench & 18mm socket.
4. Install the shock absorbers on the new bracket with the supplied flat washers as shown in Photo 3 on both sides of the shock and secure with the factory hardware. Tighten using a 18mm wrench and 15mm socket. **Stock Shocks Shown in picture.**

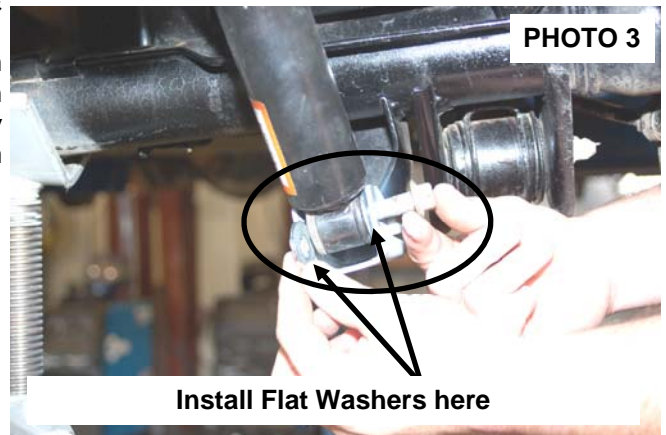

POST INSTALLATION

1. Check all fasteners for proper torque. Check to ensure there is adequate clearance between all rotating, mobile, fixed and heated members. Check steering for interference and proper working order.
2. Re torque all fasteners after 500 miles. Visually inspect components and re torque fasteners during routine vehicle service.

Thank you for choosing Rough Country for your suspension needs.

**ROUGH
COUNTRY**
SUSPENSION SYSTEMS