



24 - UP Tacoma Hidden Winch

Thank you for choosing Rough Country.

Rough Country recommends that a certified technician install this system. In addition to these instructions, professional knowledge of disassemble/reassembly procedures as well as post installation checks must be known. Attempts to install this system without this knowledge and expertise may jeopardize the integrity and/or operating safety of the vehicle. Please read all the instructions before beginning the installation. Check the kit hardware against the "Kit Contents" list below. If question exist, please call us @1-800-222-7023. We will be happy to answer any questions concerning this product. Check all fasteners for proper torque. Check to ensure for adequate clearance between all components. Check and retighten wheels at 50 miles and again at 500 miles. Periodically check all hardware for tightness. Be sure you have all the needed parts and understand where they go. Also, please review the "Tools Needed" list to be certain you have the necessary tools to complete the installation.

NOTICE TO DEALER AND VEHICLE OWNER

⚠WARNING Any vehicle equipped with any Rough country product must have the "Warning to Driver" decal installed on the sun visor or dash. The decal is to act as a constant reminder for whoever is operating the vehicle of its unique handling characteristics. **INSTALLING DEALER**—It is your responsibility to install the warning decal and to forward these installation instructions on too the vehicle owner for review and to be kept in the vehicle for its service life.



Factory Fender Flare Models

1. These steps refer to a TRD Off-Road and any other package vehicles with factory fender flare as the tear down is slightly different than that of the SR5 and base models. You will skip to the main instructions when finished. **Photo 1**
2. Start by removing the fender flares. Use a 10mm socket to remove all hardware from the fender flare where it attaches to the fender. Note that there are two sizes of the screws that are removed. You will have a short screw with blank head and a long screw with a Phillips cross in it. Both use a 10mm socket to remove. **Photo 2**



3. Remove the plastic rivets using a pry tool. **Photo 2**
4. Pull out on the fender flare to pop the remaining clips out of the fender and set aside. **Photo 3**

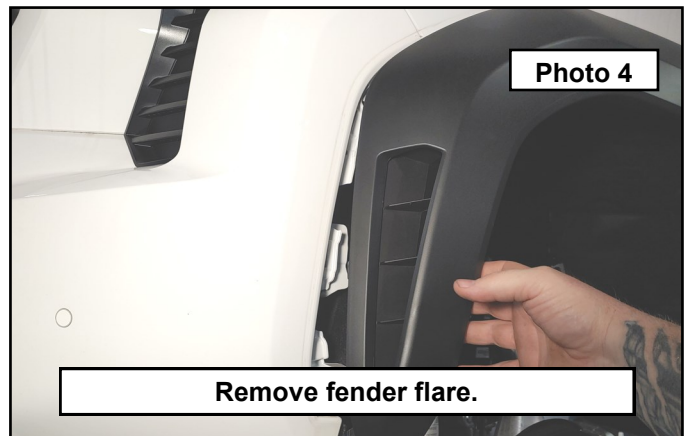

5. Remove the Phillips head screw from the front fascia. **Photo 5**
6. Use a pry tool to disengage the clip from the fascia. You will have to pull out and down on the fascia while looking closely for the clip. The pry tool must be inserted between the clip and the fascia to have it release. **Photo 6**
7. Skip over to the main instructions to follow the rest of the fascia removal.

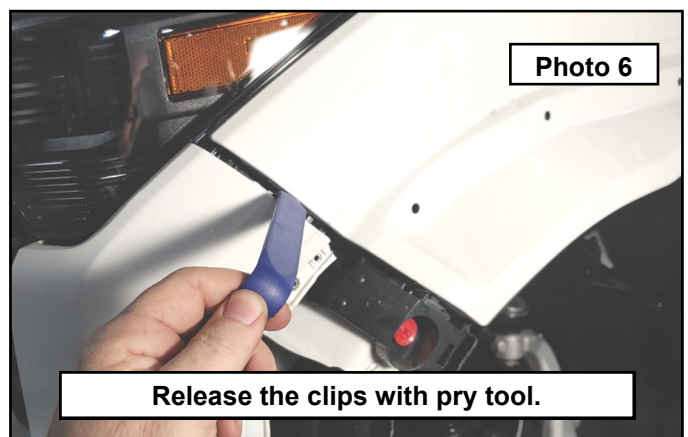
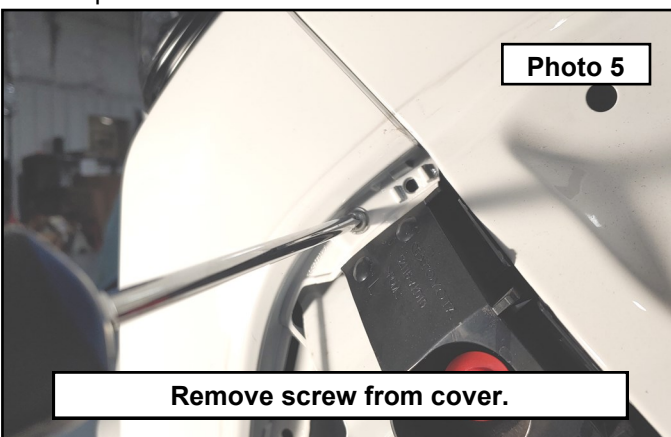

Plastic Gravel Guard Models

1. Use the tear down instructions for removal of the front facia. Vehicles with the plastic gravel guard that looks like the one shown here will need to follow these steps to complete the installation. Look under the vehicle for this full width plastic guard. Remove using a 12mm socket and discard. **Photo 1**
2. Remove the differential guard using a 12mm socket and discard. **Photo 2**

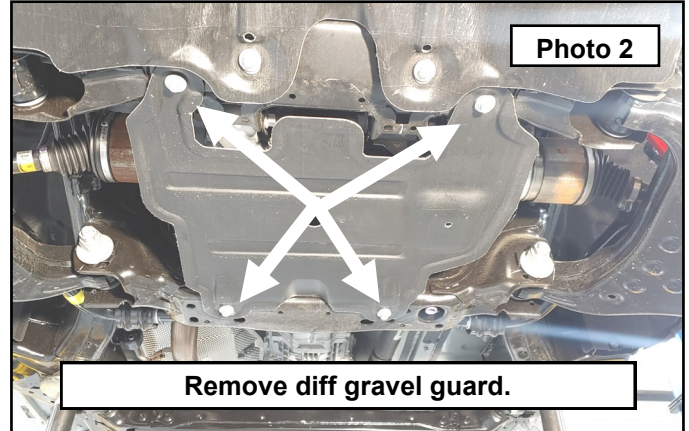
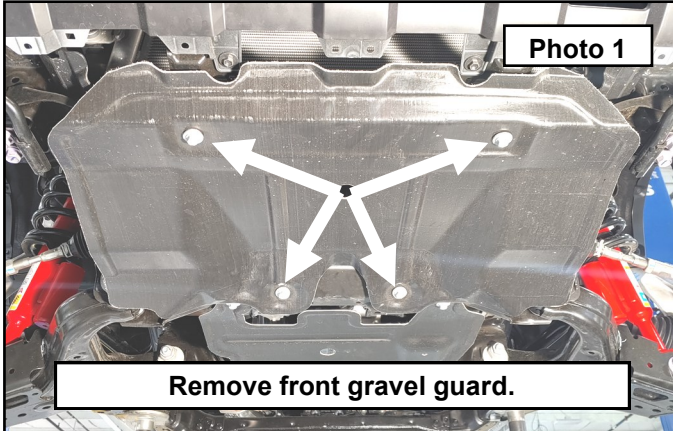

3. You will be left with this cross member between the frame horns where the tow rings are located and will need to be cut out. **Photo 3**
4. Remove the tow rings using a 17mm socket and set aside. **Photo 4**

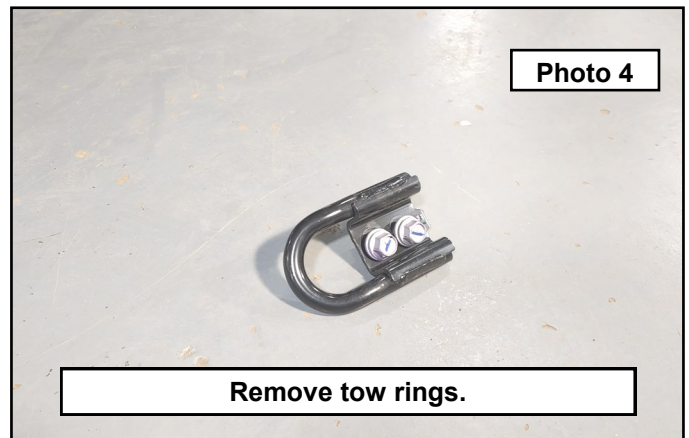
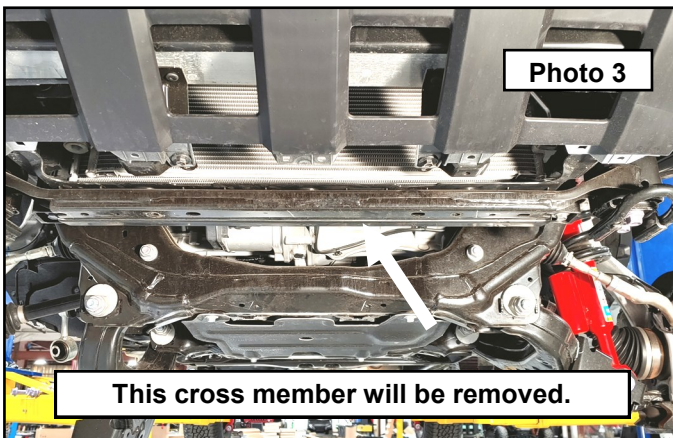

5. On top of the cross member is a plastic filler panel held on by plastic rivets. Use a small pry too to pop the heads up on the rivets and then pull the body out of the holes. Do this for the entire panel and then remove. **Photo 5 / 6**

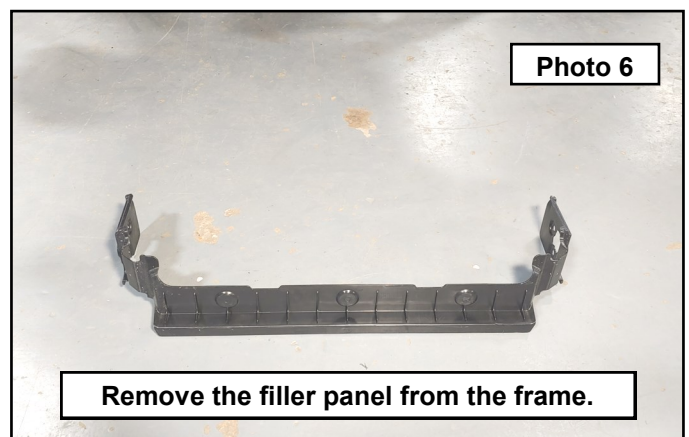
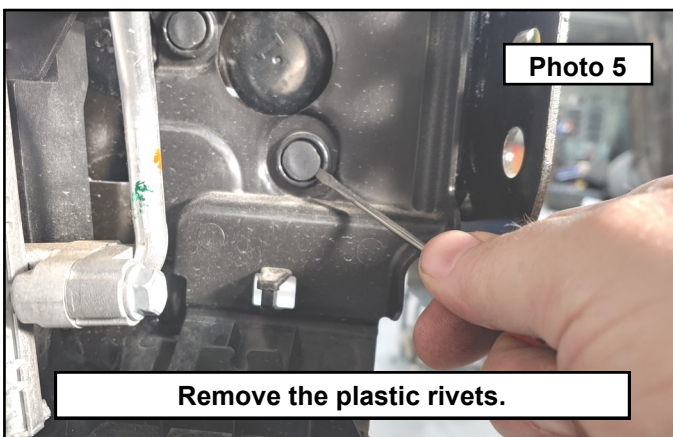

6. Mark the cross member where it meets the frame horns as shown. Repeat for the opposite side. **Photo 7**
7. Use a cutting tool (reciprocating saw shown) to remove the cross member. **Photo 8**

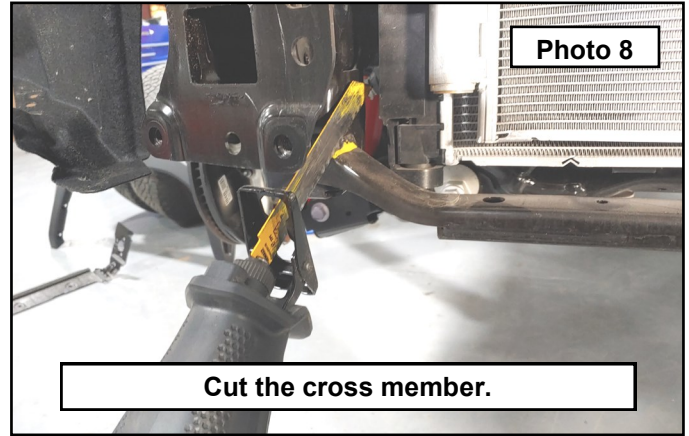
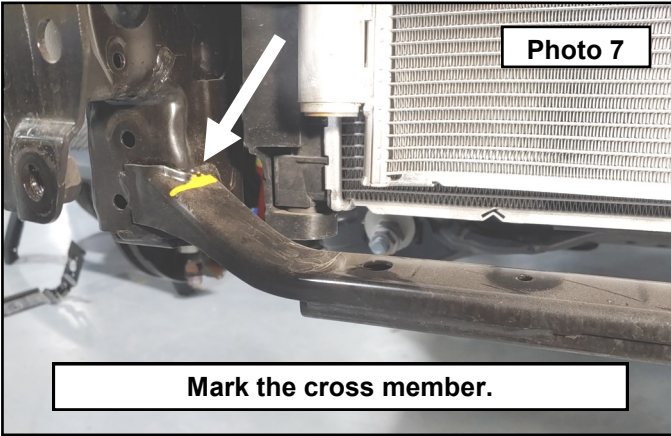

8. Discard the cross member. **Photo 9**
9. Sand the frame smooth and paint the exposed metal with a quality rust preventative paint. **Photo 10**

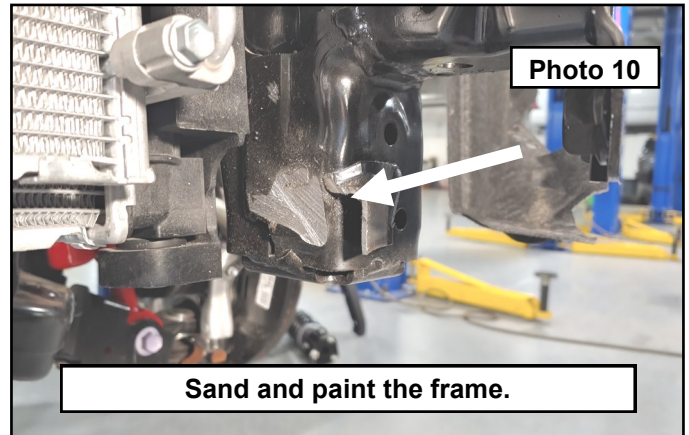
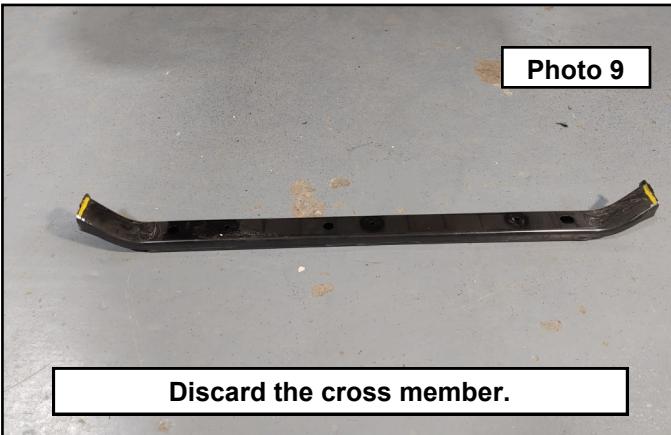

***** Vehicles with plastic gravel guard and front cross member, skip back to page 9 for the rest of the installation of the hidden winch system*****

24 - UP Tacoma Hidden Winch

TOOLS NEEDED:

Jack
Safety Stands
Wheel Chocks
Wire Cutter
Body Saw
Sander

Metric Wrench/Socket

10mm
12mm
13mm
18mm
19mm

SAE Wrench/Socket

1/2" Wrench

KIT CONTENTS:

Winch Tray
Fairlead Mount
Driver Wing
Pass Wing
Core Skid Plate
Diff Skid Plate
Driver Skid Plate Bracket
Pass Skid plate Bracket
5/8" Thick Spacers (2)
Extension Cable

HARDWARE INCLUDED:

11 Zip Ties (6)
Phillips Head Screw (2)
12mm x 35mm Bolt (18)
12mm x 55mm Bolt (2)
12mm x 35 Socket Bolt (2)
12mm Flange Nut (20)
12mm Washer (18)
5/16" Nutsert (4)
5/16" x 3/4" Bolt (4)
5/16" x 1.5" Bolt (1)
8mm Black Washer (8)
8mm x 20mm Black Bolt (4)
10mm Flange Nut (2)



Front Facia tear down

1. Park your vehicle on a clean flat surface, engage the parking brake and block the rear tires.
2. **Save all hardware removed from the vehicle unless otherwise noted.**
3. Open the hood and disconnect the negative terminal on the battery.
4. This kit requires removal of the front bumper cover. Remove the core support cover rivets by pressing the center button down and then pulling out of their locations. Remove the core support cover and set aside. **Photo 1 / 2**

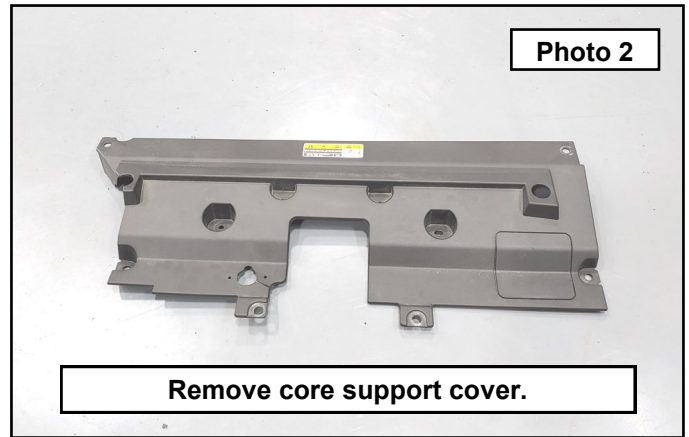

5. Remove the air intake with the same procedure as the core support rivets. **Photo 3 / 4**

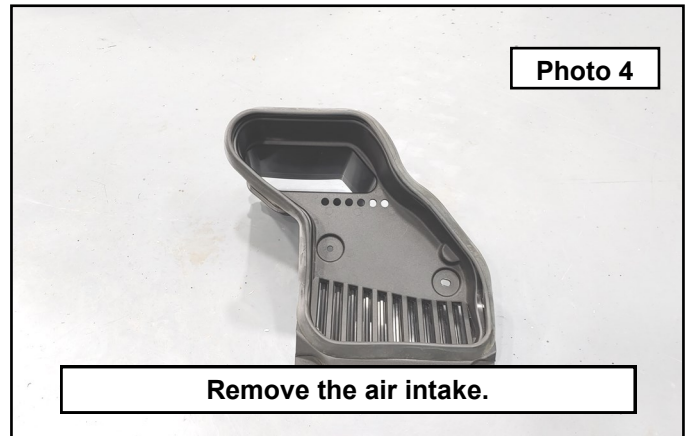

6. Once out, reset the rivet button by pressing it back up into the body for reinstallation later. **Photo 5**
7. On the passenger side of the grill, disconnect both electrical connectors. **Photo 6**

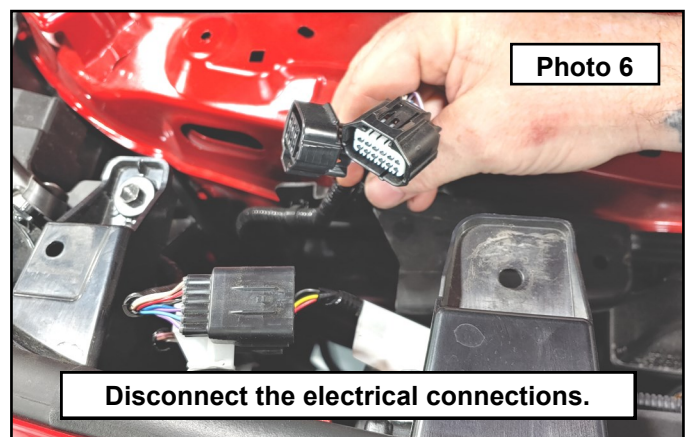
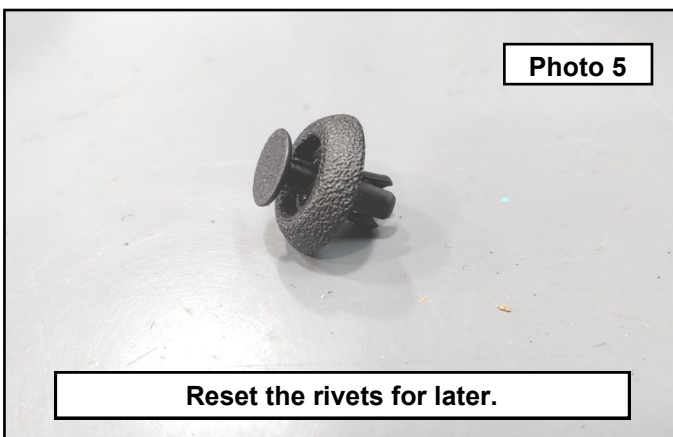

8. Remove the fender well hardware that attach to the bumper cover using a 10mm socket. **Photo 7**
9. Remove the fender well plastic rivets by prying them out using a pry tool. **Photo 8**

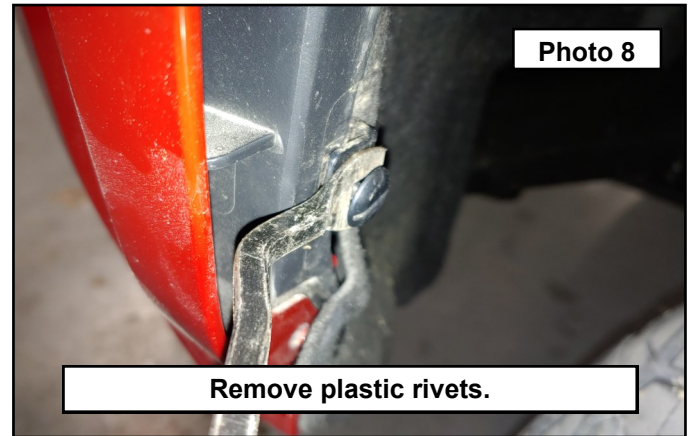
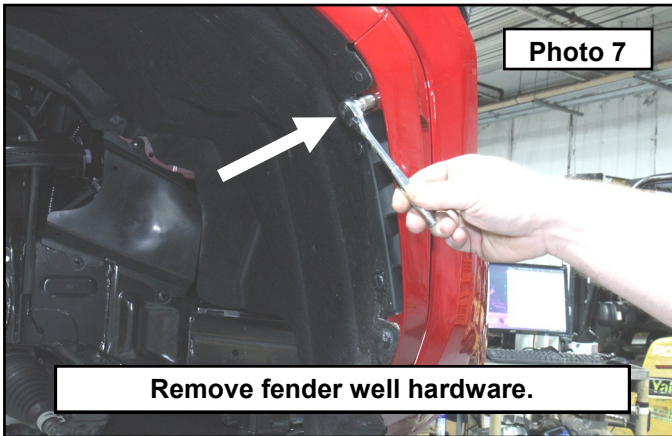

10. Remove the fender liner under the bumper using a 10mm socket. **Photo 9**
11. Remove the bumper cover from the inner bumper brackets using a 10mm socket. If you have the felt covered gravel guard, remove now using a 12mm socket and discard. **Photo 10**

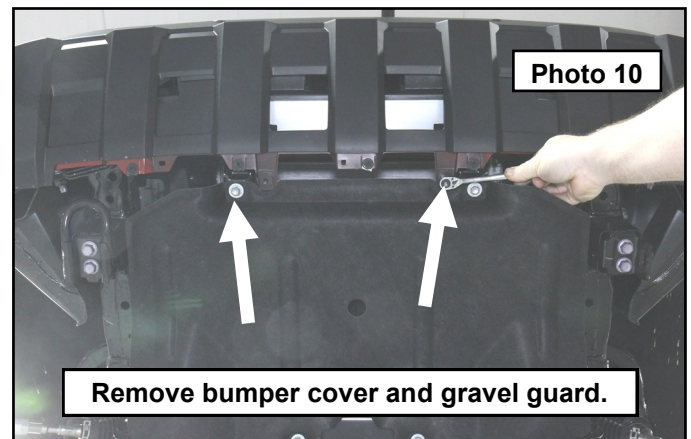
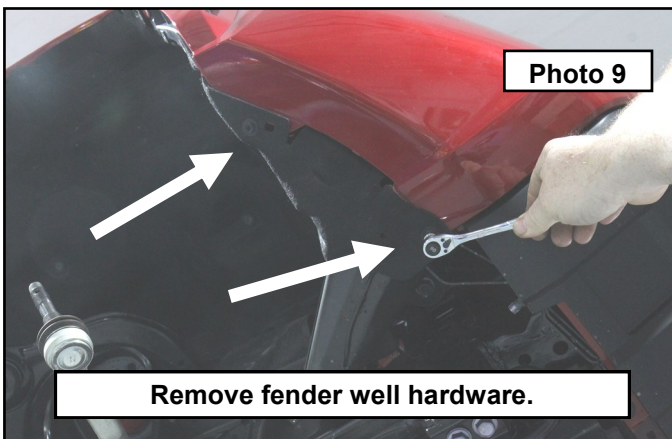

12. Remove the upper facia hardware using a 10mm socket. **Photo 11**
13. Gently pull on the bumper cover at the point at which it meets the fender edge. There is a hidden clip system at this joint. You will need to use a plastic pry tool to release the clips. **Photo 12**

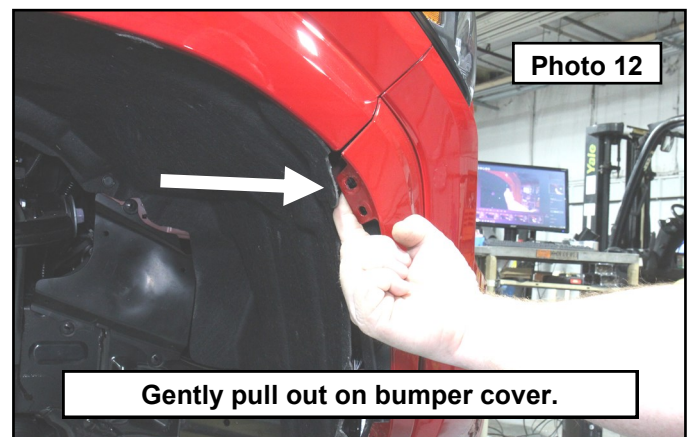
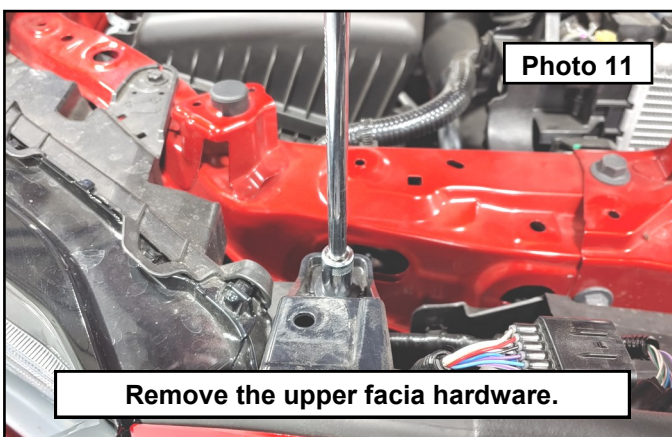

14. Look closely into the gap created by pulling out on the cover and you will see the black clips that hold the cover in place. Pry this up enough to disengage the locking tab while still pulling out on the bumper cover. **Photo 13**
15. Once you have the first tab released, move forward to find the second locking tab. Repeat the process to disengage the locking tab while pulling bumper cover out of the joint. Repeat the process for the other side of the vehicle once the bumper cover is loose from the fender. **Photo 14**

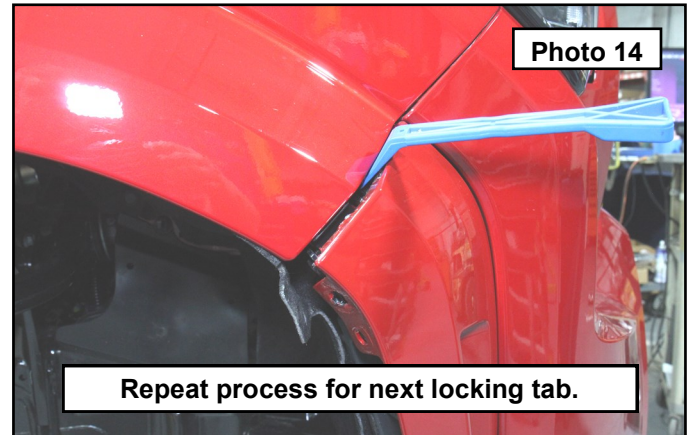
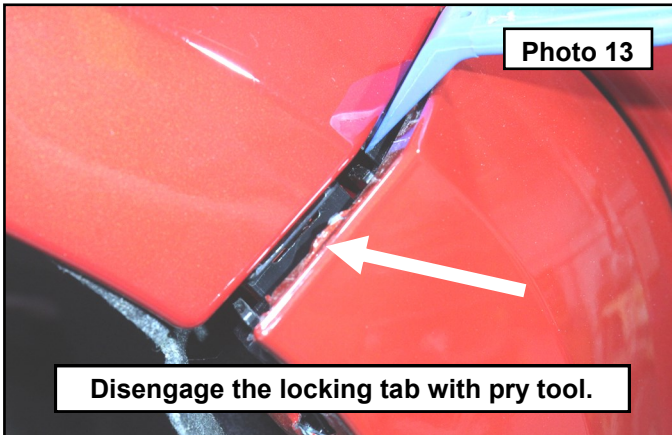

16. With both sides of the bumper cover released from the fender, lift up on the tabs where the upper hardware is located and then pull the front fascia away from the vehicle. There are 3 clips in the middle of the bumper cover that will “pop” loose as you pull the assembly away from the vehicle. Set the fascia aside on a protected surface to avoid any damage. (Your bumper will not have the fairlead hole at this time.) **Photo 15 / 16**

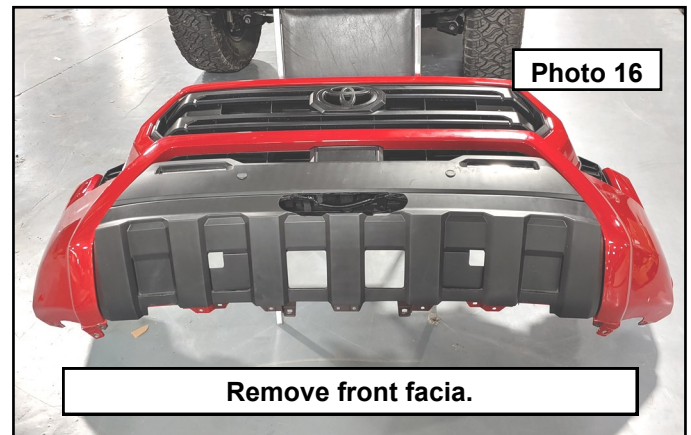
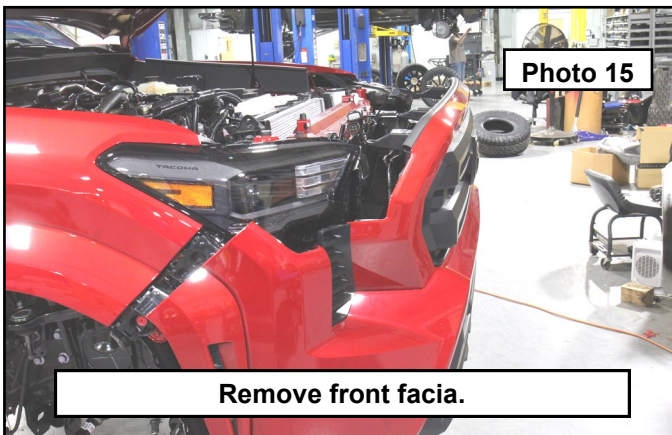

17. At the ends of the inner bumper structure, remove the 3 bolts using a 17mm wrench. **Photo 17**
18. Remove the 2 lower bolts using a 17mm wrench. If you have the Rough Country shackle mounts installed, remove the inside bolt using a 19mm wrench. You will be replacing this bolt with one from this kit later. **Photo 18**

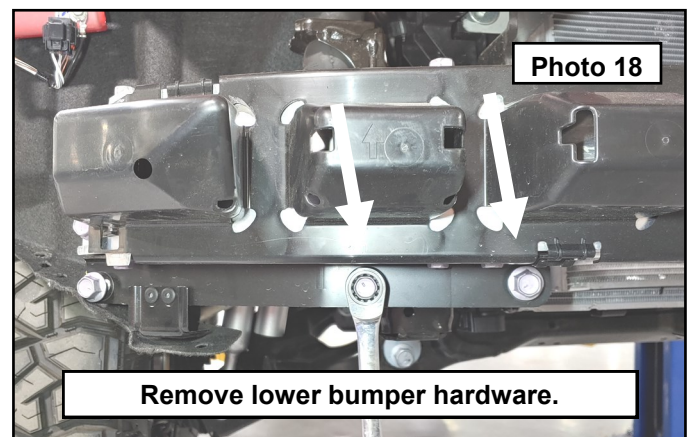
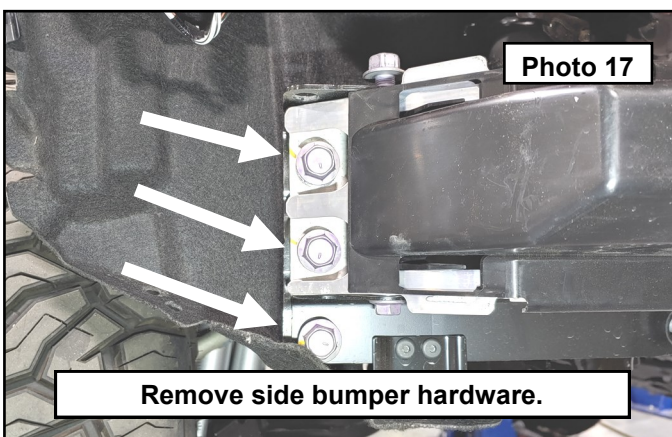

19. Remove the upper bumper hardware using a 17mm socket. **Photo 19**

20. Remove the inner bumper structure from the vehicle. **Photo 20**

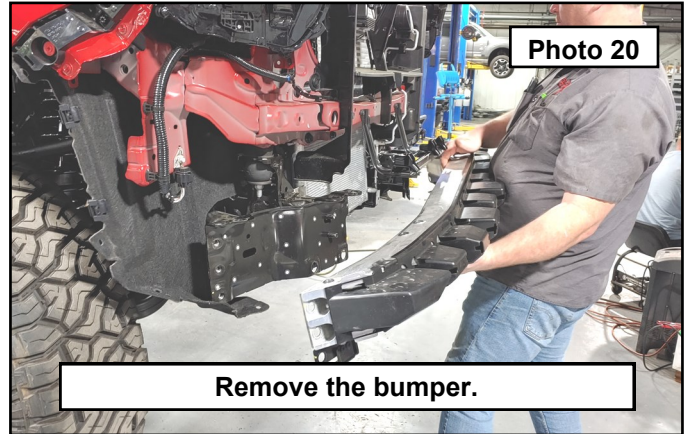
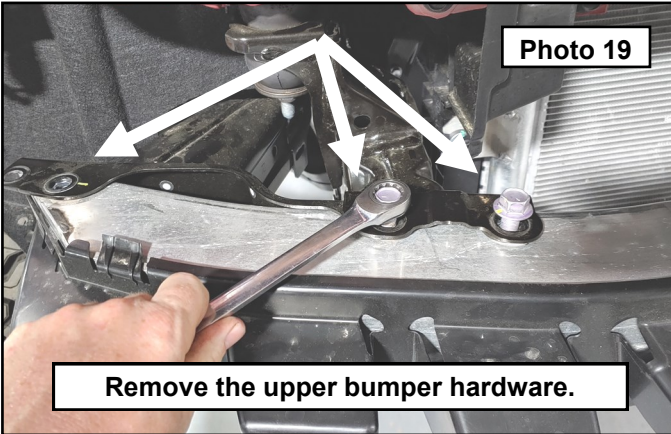

***** Vehicles with plastic gravel guard and front cross member, skip to page 3 at the beginning of this booklet where the tear down is shown for this model*****

Hidden Winch Installation

21. Lay out the skid plates and skid plate hardware, four 5/16" (gold) bolts, one 5/16" (silver) bolt, four 5/16" nutserts, four 8mm (black) bolts, 8 (black) washers, and two 10mm flange nuts (black). Arrow point to locations for nutsert installation. **Photo 21**
22. If you have a nutsert tool ignore this step. Assemble the silver 5/16" bolt, 10mm flange nuts and nutsert as shown with the nut heads facing each other. **Photo 22**

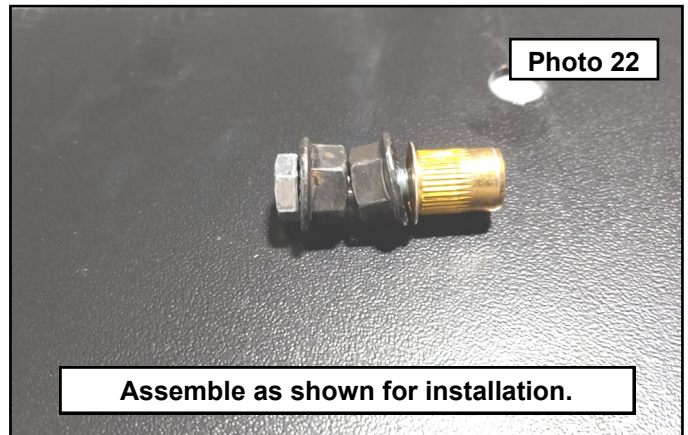
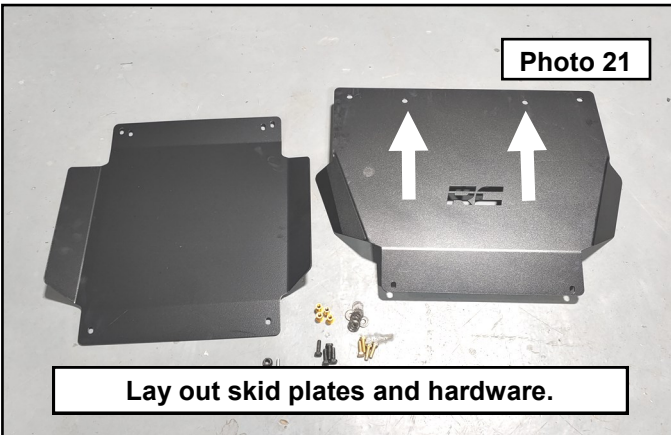

23. Two of the nutserts will be installed into the skid plate (shown in Photo 23) and one in each of the skid plate mounts. On the front skid plate (with logo) there are two holes at the top that will accept the nutserts. Make sure to have the skid plate with the logo facing you and insert the assembled nutsert and hardware into the hole. Use a 15mm wrench to hold the black flange nut and nutsert still while tightening the 5/16" bolt using a 1/2" wrench. Tighten until the nutsert is fully seated as shown. If you have a nutsert tool, follow instructions for tool. Repeat the process for the other hole in the skid plate. **Photo 23 / 24**

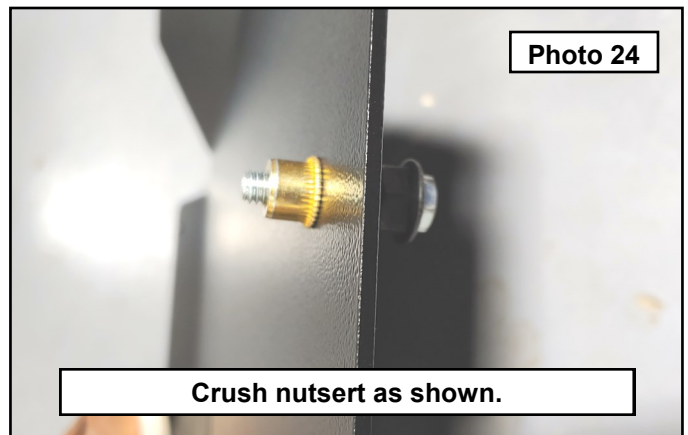
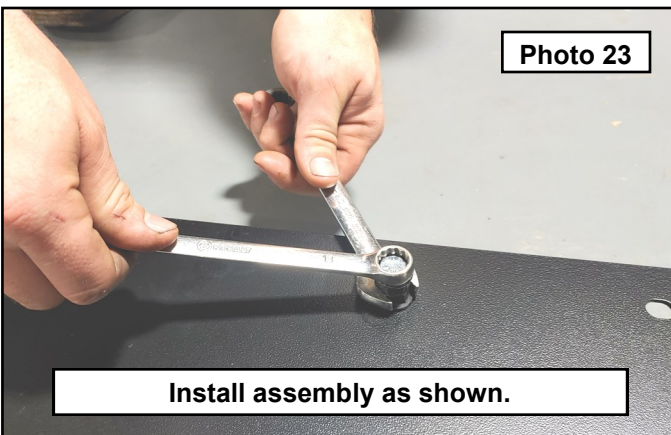

24. Lay out the parts of the hidden winch kit. Driver side wing, pass side wing, winch tray, fairlead mount, driver skid plate mount, pass skid plate mount and hardware. **Photo 25**
25. Install the remaining nutserts into the skid plate mounts as shown. Use the same process as the skid plate install. The top of the nutsert will need to be on the outside face of the bracket. **Photo 26**

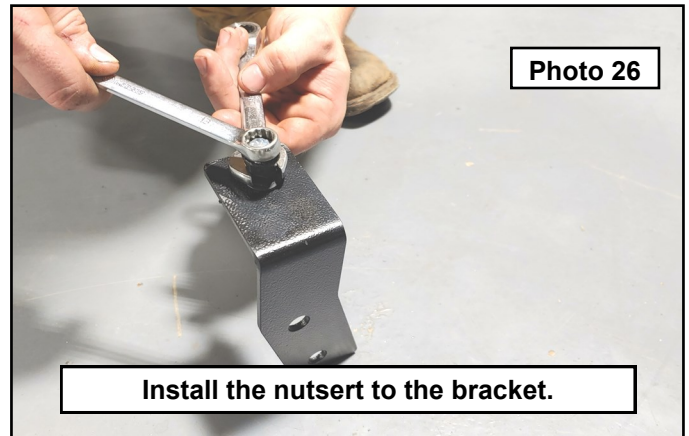
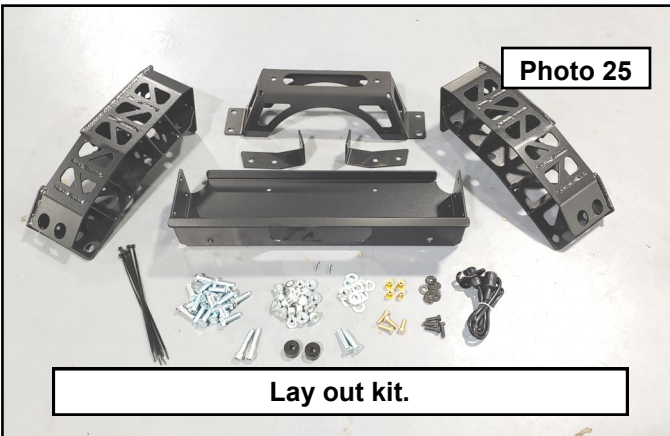

26. Lay out the winch tray, driver wing, pass wing, driver skid plate mount, and passenger skid plate mount. **Photo 27**
27. Line up the wings with the holes in the side of the winch tray. **Photo 28**

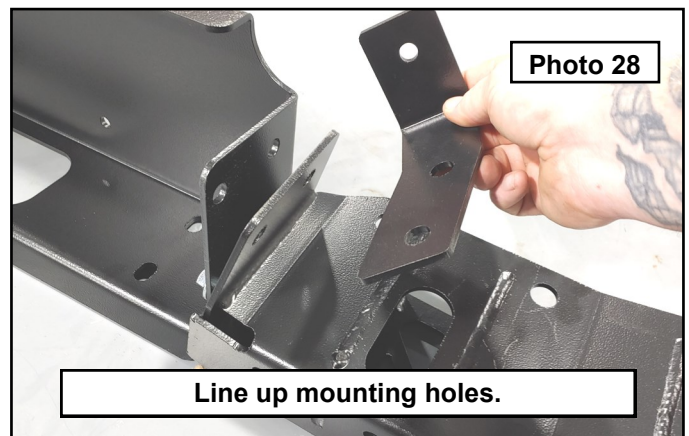
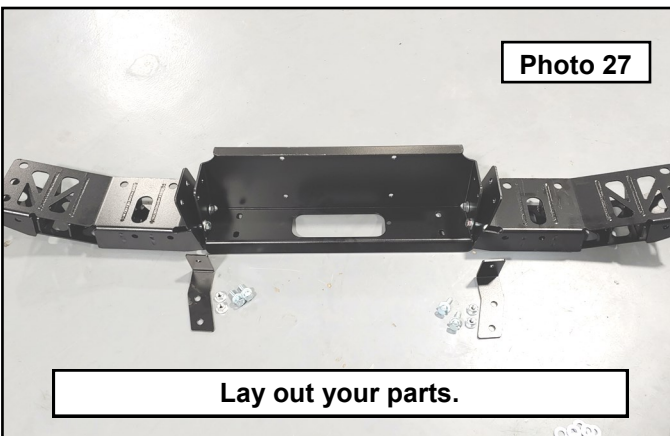

28. Install the skid plate mounts and the wing to the winch tray using the provided 12mm bolts, washers and flange nuts. When installing the hardware, make sure the head of the bolt is to the inside of the winch tray. Washer goes against the head of the bolts. Square the winch tray to the wings and torque the front hardware to 65 ft-lbs. The skid plate mounts will be torqued down in a later step. Note how the skid plate mount angles to the front of the winch tray. **Photo 29 / 30**

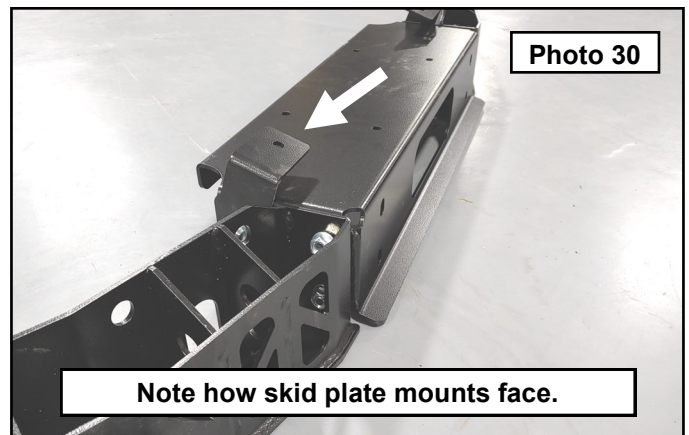
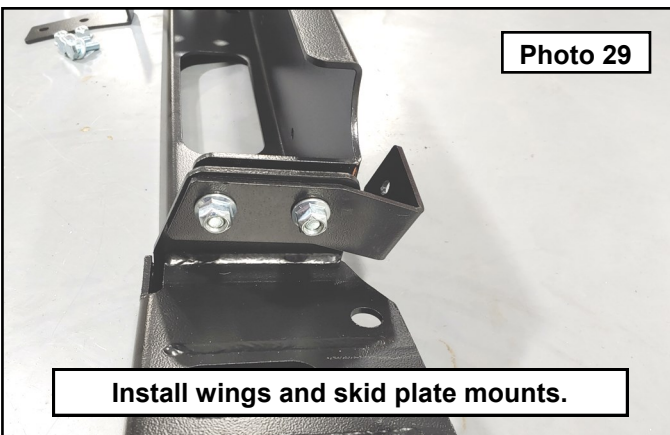

29. Install the fairlead mount to the front of the winch tray using the provided 12mm bolts, washer, and flange nuts. Install the bolts from the inside of the winch tray outwards and install so that the fairlead is angled up away from the bottom of the tray. Only snug the hardware so that you can adjust later. Final torque to be done after adjustment. **Photo 31 / 32**

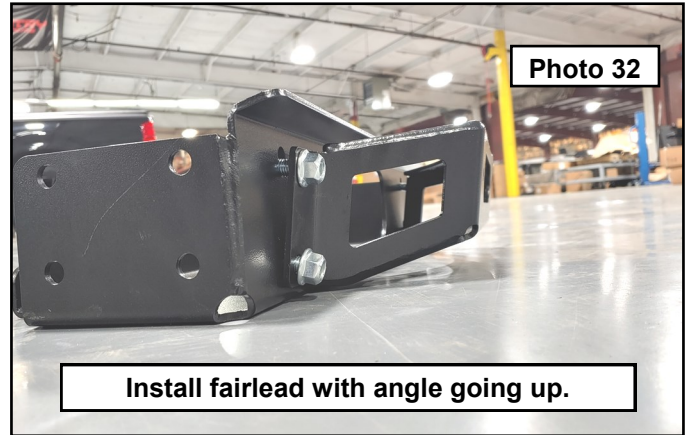
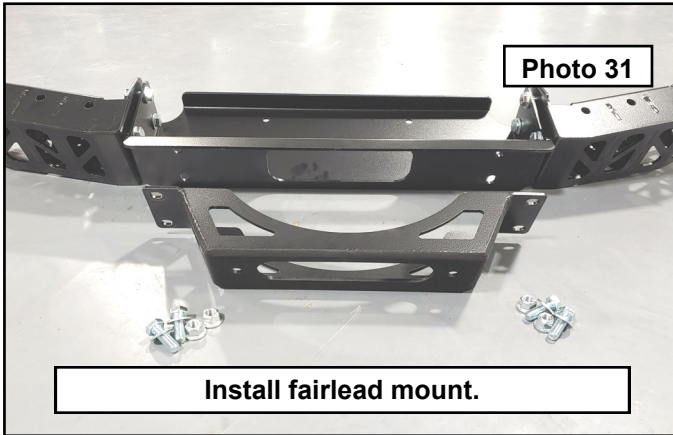

30. Set the winch upside down onto its control box. Install the provided hardware that came with the winch feet. Set the assembled hidden winch tray upside down onto the winch feet and install the hardware. Torque the hardware to 35 ft -lbs. **Photo 33 / 34**

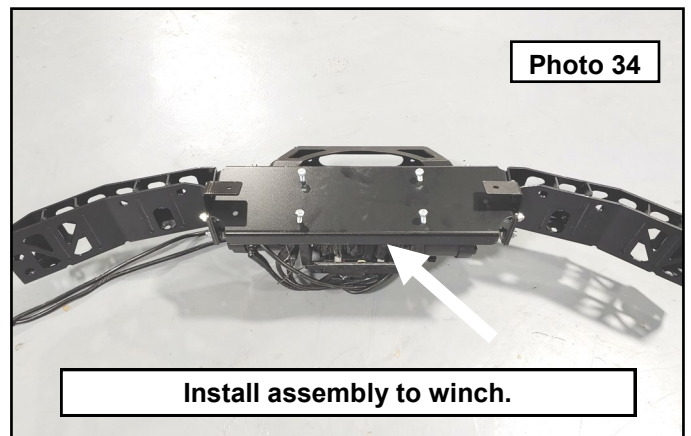
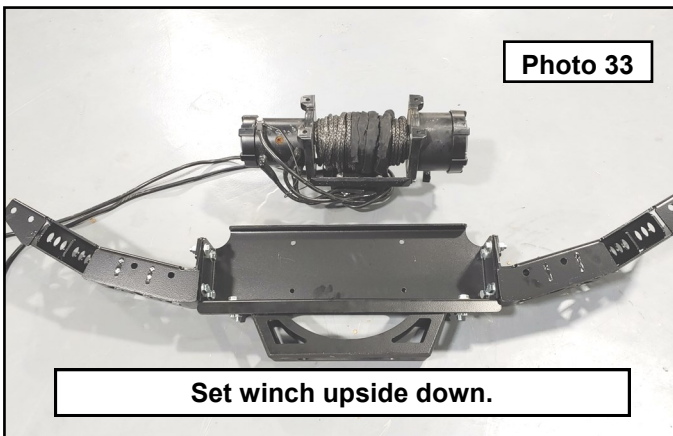

31. Use a jack to raise the completed assembly up to the vehicle frame rails. Line up the holes in the wings with the locations on the frame rails. Install the factory hardware into the outside lower mounting location. Snug the hardware down but do not fully tighten. **Photo 35**
32. Install the previously mentioned 12mm x 55mm fine thread bolt and washer into the inside lower hole using a 19mm wrench. Do not fully tighten at this time. This is done so that you can install the Rough Country shackle mounts if you already have them or opt to purchase later. **Photo 36**

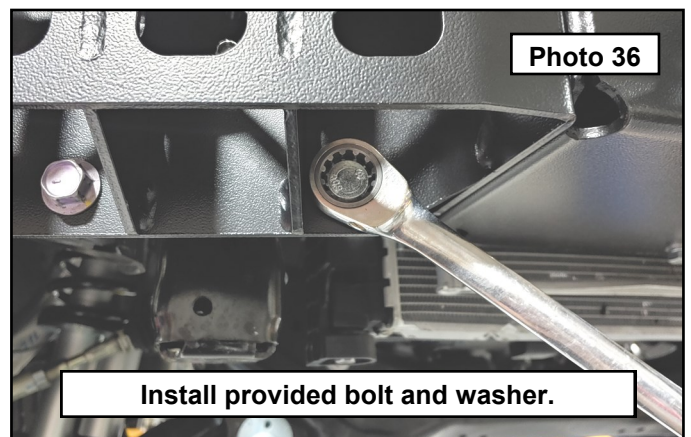
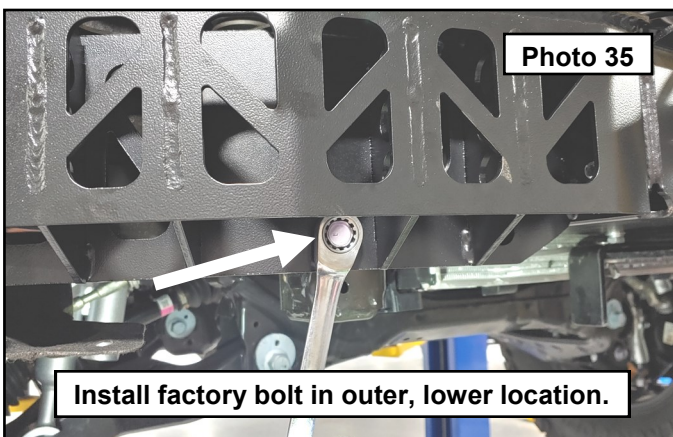

33. Install the provided 12mm bolts, washers and flange nuts into the upper bumper mounting locations. Do not fully tighten at this time but have snug. **Photo 37 / 38**

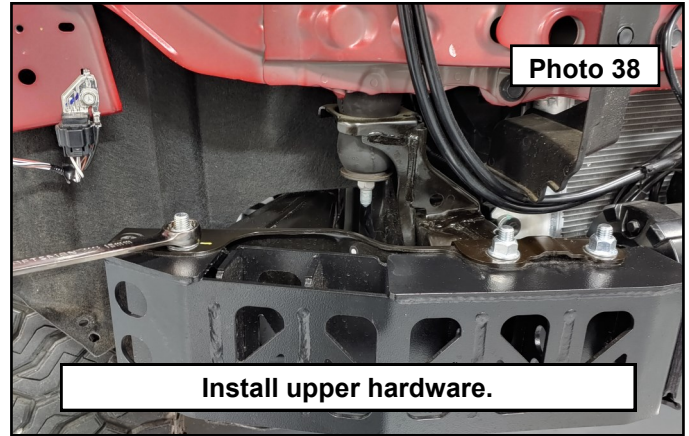
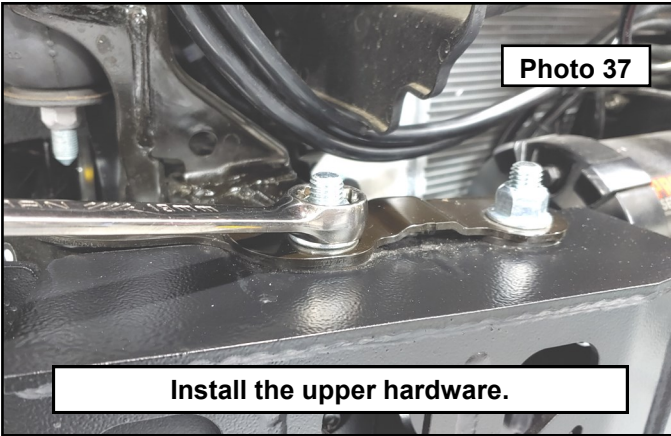

34. Install the factory hardware to the end of the wings using a 17mm wrench. Torque all hardware for the bumper to 65 ft-lbs now that every one is in place. **Photo 39**

35. Route the positive and negative cable of the winch up the core support and behind the passenger headlight, around the air box and to the battery. Use the provided zip ties to cable tie the leads out of the way. **Photo 40**

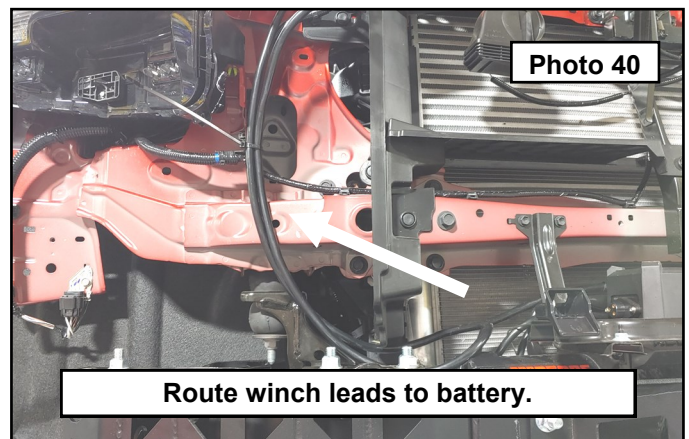
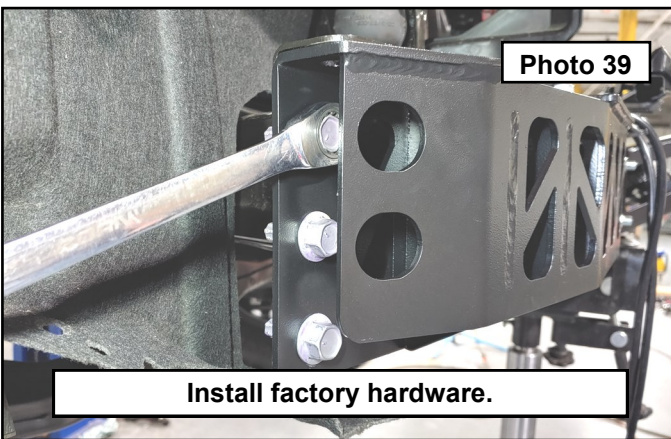

36. Route the positive winch cable under the plastic cover of the battery and attach to the stud on the positive clamp using a 12mm socket. Attach the negative winch cable to the stud on the negative clamp using a 12mm socket. Replace the plastic cover over the positive post. **Photo 41 / 42**

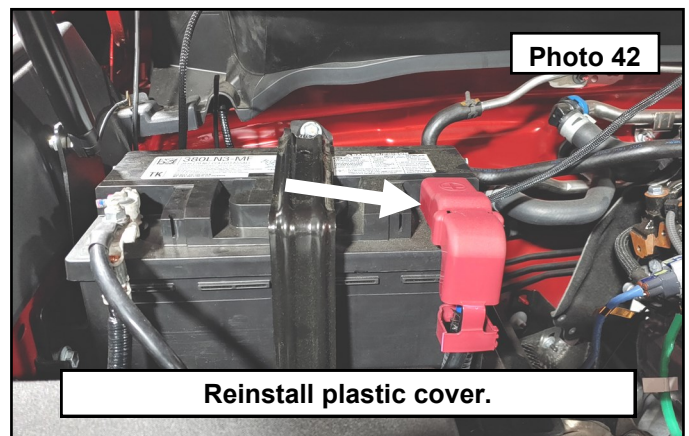
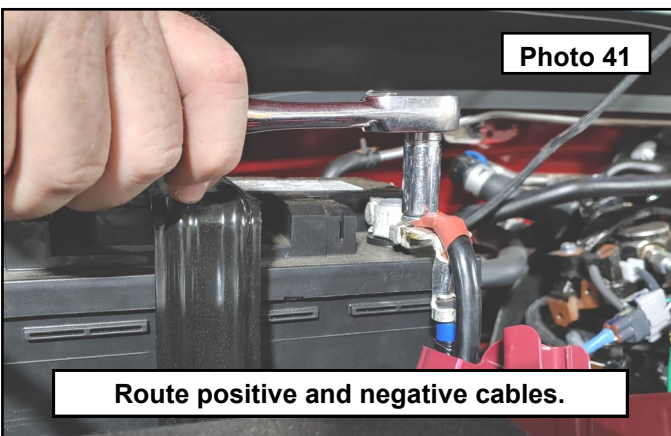

37. Locate the winch controller extension. Remove the cover from the extension for installation later. **Photo 43**

38. Connect the provided cable extension into the winch control box. **Photo 44**

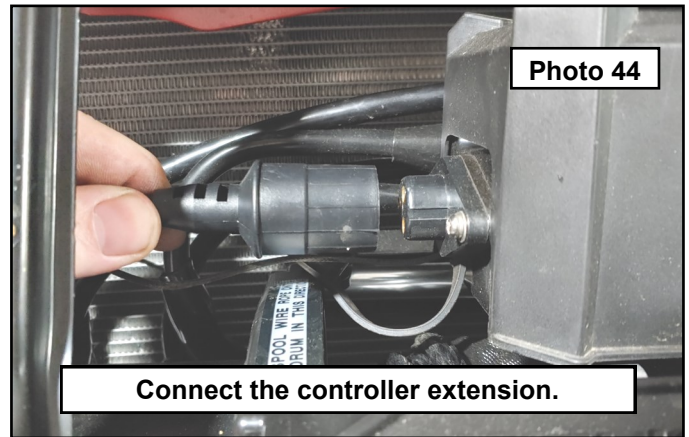
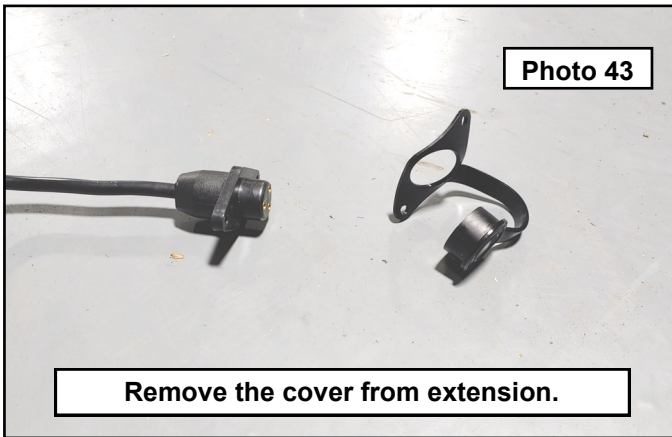

39. Route the cable extension up and over to the middle of the core support. Cable tie out of the way. **Photo 45**

40. Attach the diff skid plate to the front and rear cross member factory threaded hole locations using the provided 8mm bolts and black washers and 13mm socket. Note that the rear bolt locations are not symmetrical as shown in the photo. Torque the rear bolts to 25 ft-lbs. Remove front bolts to install front skid plate. **Photo 46**

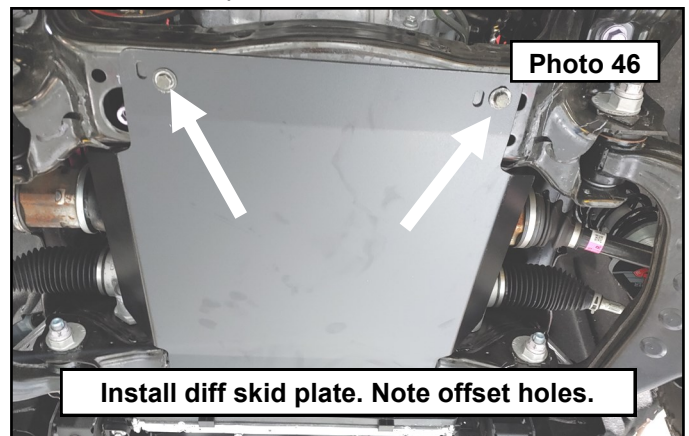
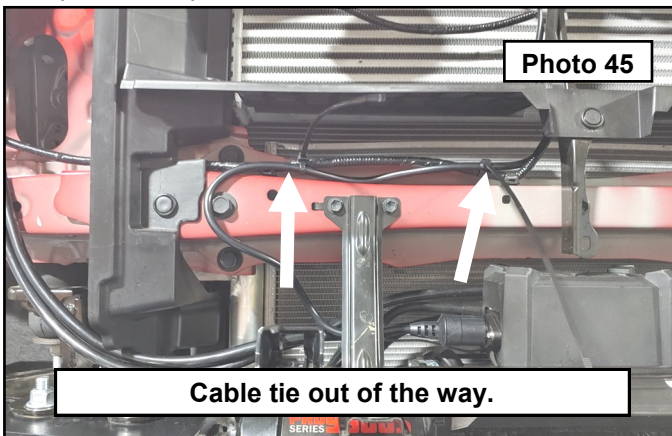

41. Install the front skid plate so the diff skid is sandwiched between it and the crossmember using the 8mm bolts and washers from above step and front mounting points using the 5/16" (gold) hardware and black washers. The front mounts are adjustable so move as needed to line up the mounting holes. Once the skid plate mounts have been attached, torque the locations on the winch tray to 65 ft-lbs and the other points to 25 ft-lbs. **Photo 47 / 48**

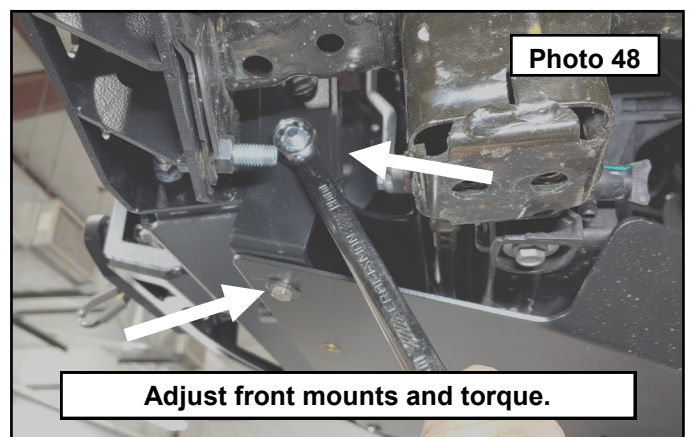
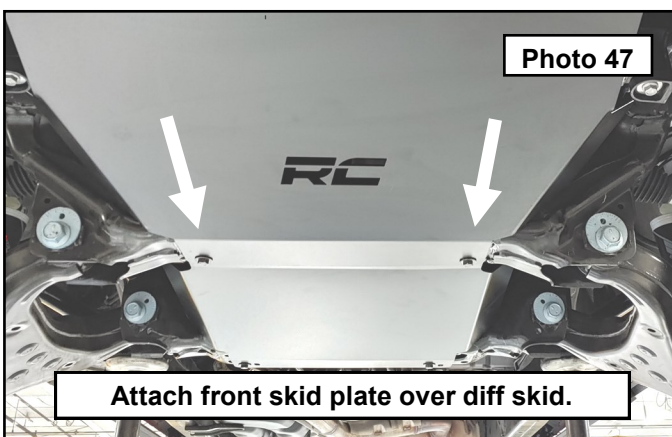

42. Apply painters tape on the lower portion of the bumper cover and mark the center line. **Photo 49**

43. Hold the fairlead centered on the tape. **Photo 50**

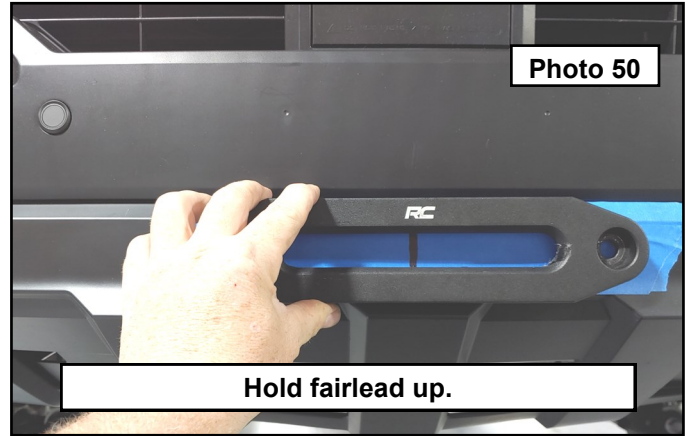
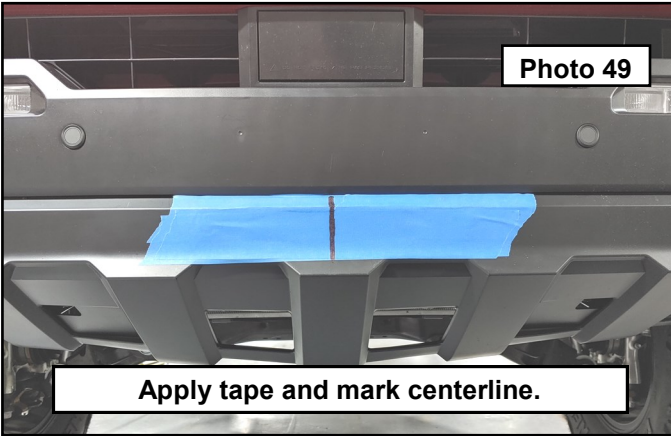

44. Trace around the fairlead. Stay below the top portion of the bumper cover. **Photo 51**

45. Use an appropriate cutting tool to cut to the inside of the traced line. Stay below the crease between the two halves of the bumper cover. You should not be cutting anything out of the upper portion of the bumper cover. **Photo 52**

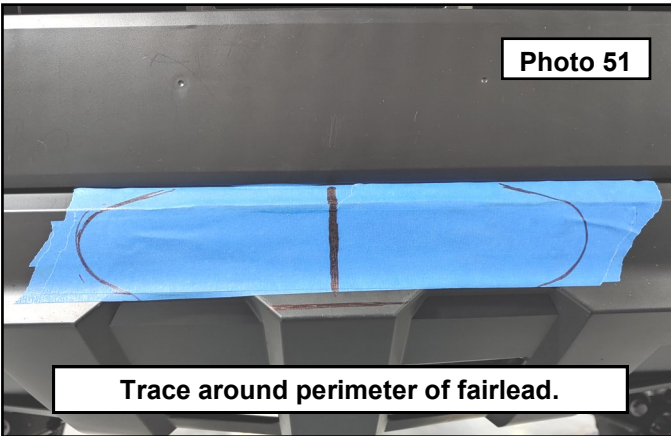

46. Hang the facia onto the core support without clipping in the fenders. Check to see if the fairlead mount is centered through the hole. **Photo 53**

47. If the mount is not centered, remove the facia and adjust until centered. The mount is adjustable for up/down and left/right at its mounting points. Adjust the fairlead mount so that it is centered and for height behind the bumper cover. Once the location is verified, torque to 65 ft-lbs. **Photo 54**

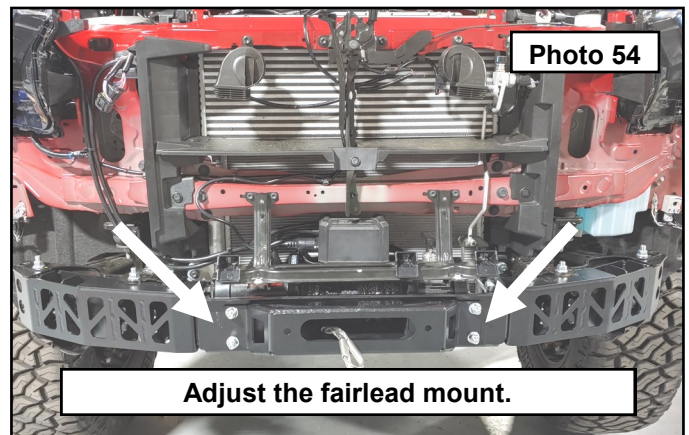
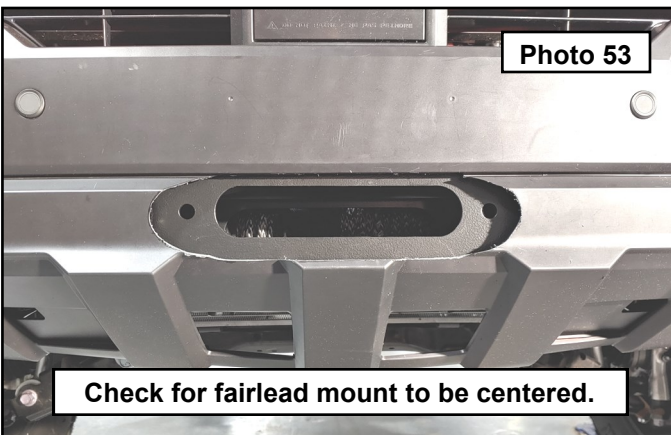

48. Locate the 12mm Socket head bolt, spacers, and flange nuts provided with the kit. Put the socket head bolt through the fairlead and a spacer behind the fairlead. **Photo 55**
49. Install the fairlead to the mount. Check for interference of the bumper cover. Repeat sanding until the desired hole is reached on the bumper cover with the fairlead centered. **Photo 56**

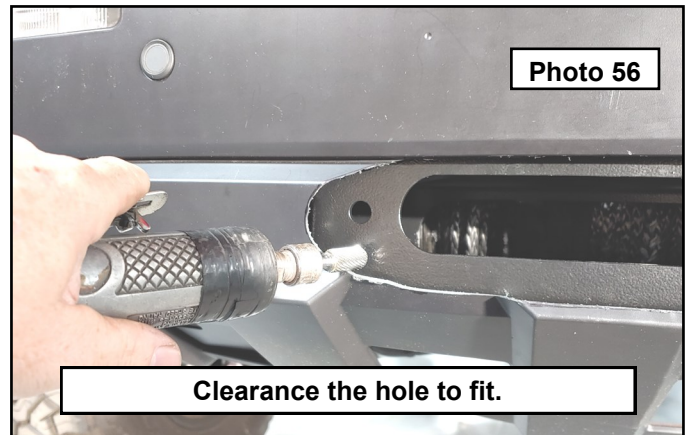
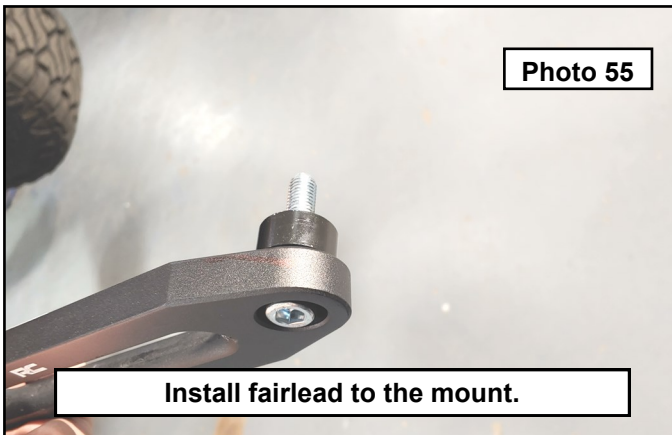

50. Once the hole is finalized, remove the fascia once more and install the fairlead to the mount. Torque to 65 ft-lbs. Pass the rope through the fairlead. **Photo 57**
51. Sand the edge smooth on the hole created for the fairlead to achieve a clean look. **Photo 58**

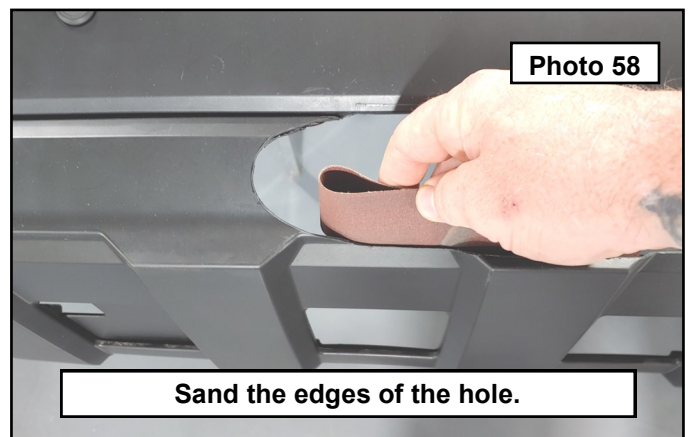
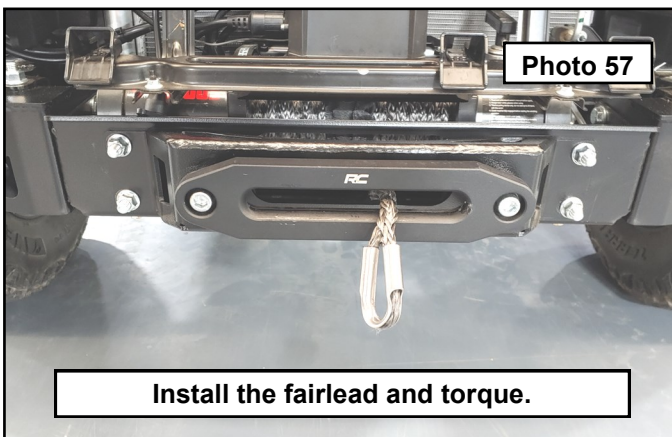

52. Find an appropriate spot to mount the controller extension. This can be installed in any location that the cable will reach that does not have any obstructions behind. Shown here going on the bumper cover. Use the cover to mark the holes to drill. Drill the outer mounting holes with a 1/16" drill bit. Drill out the center of the marked area with a 3/4" bit. Use a sander or other tool to open up the shape shown for the cover to fit through. The center hole needs to be large enough that the cover fits through. The notch at the top is for the strap of the cover to pass through. **Photo 59 / 60**

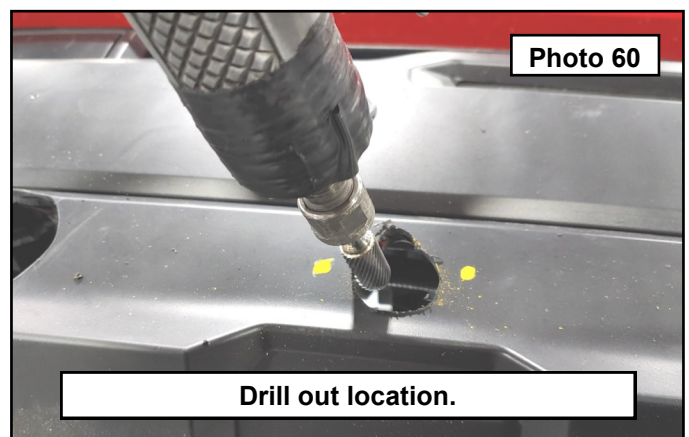
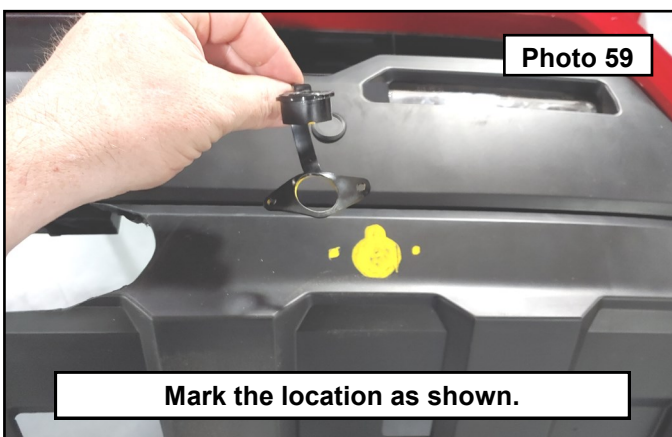

53. Clean any burrs, pass the end of the cover through the hole created and sandwich the cover between the spot picked for the hole and the cable extension. Attach using the provided self threading Phillips screws. Push the strap through the notch created for a clean look. **Photo 61**
54. Shown here in an alternate location for an idea of a customer preference mounted to the core support cover. **Photo 62**

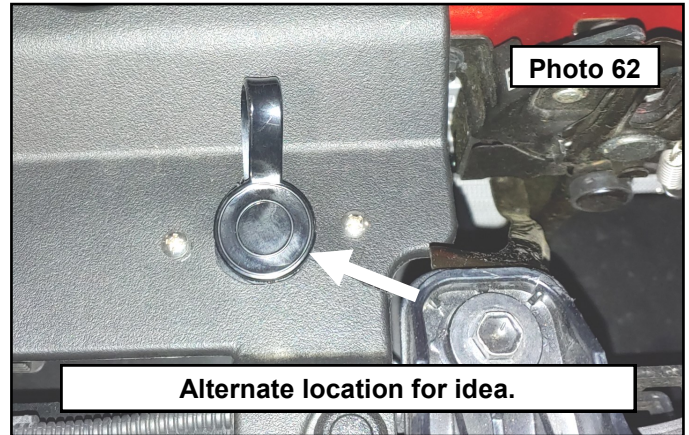
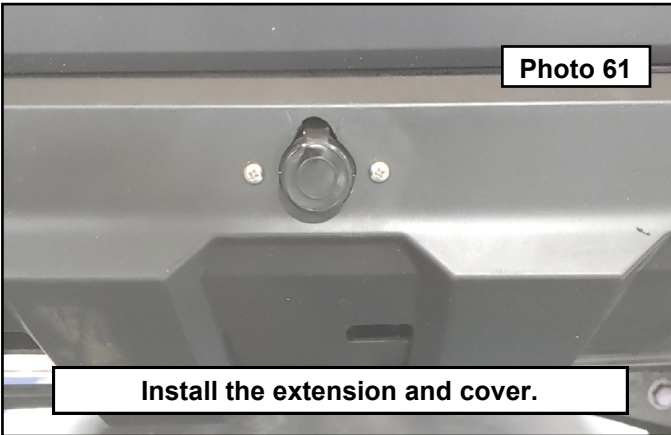

55. Reinstall the fascia in the reverse order it was removed. Make sure to put the inner fender liner into the mounts on the cover. Push the plastic rivets into place. **Photo 63**
56. Reinstall the upper mounting hardware of the fascia. **Photo 64**

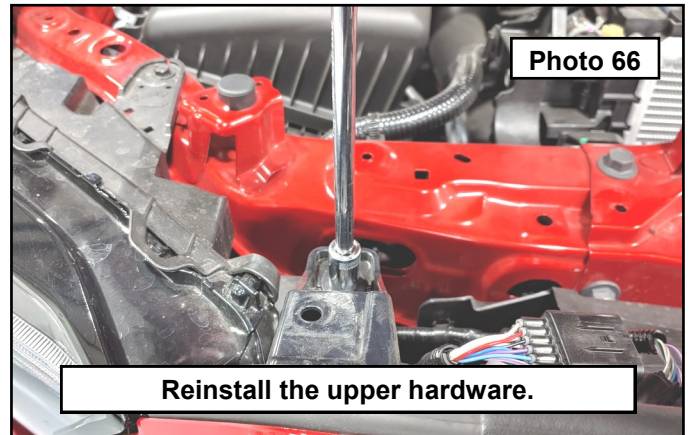
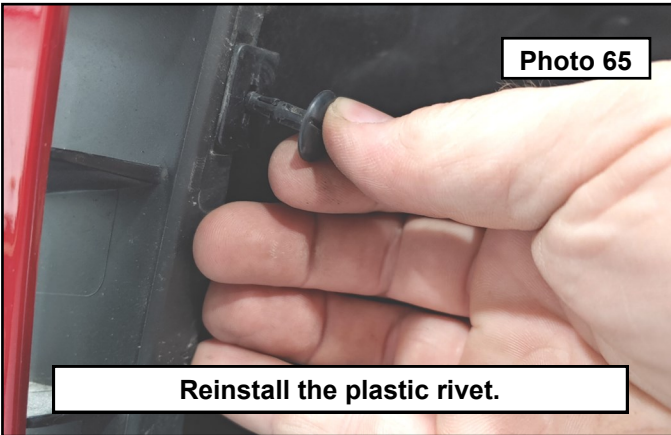

57. Reconnect the electrical connectors. **Photo 65**
58. If your bumper cover has these cross bars installed you will need to remove using a Phillips head screw driver. They can be seen through the holes of the bumper cover. They will interfere with fitting the bumper cover to the skid plate. **Photo 66**

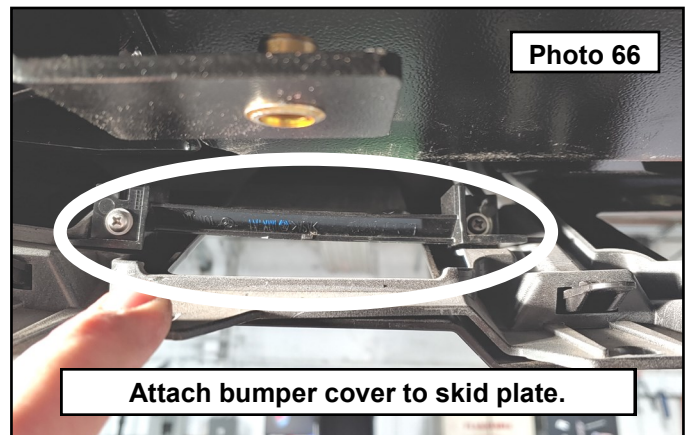
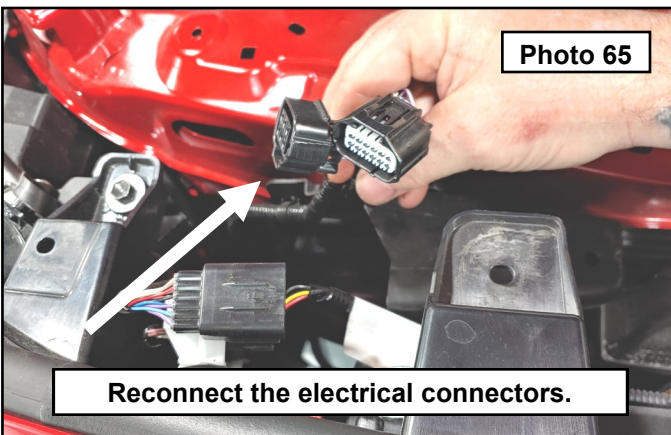

59. This is what the cross bar looks like removed. Discard all. **Photo 67**

60. Attach the lower bumper cover to the skid plate using the 5/16" (gold) bolts and black washers. **Photo 66**

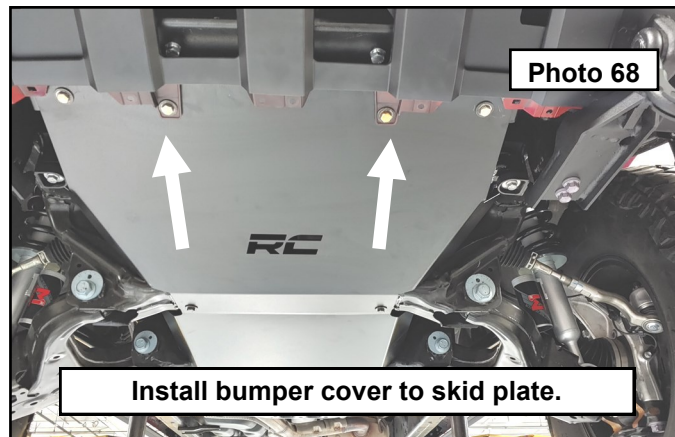
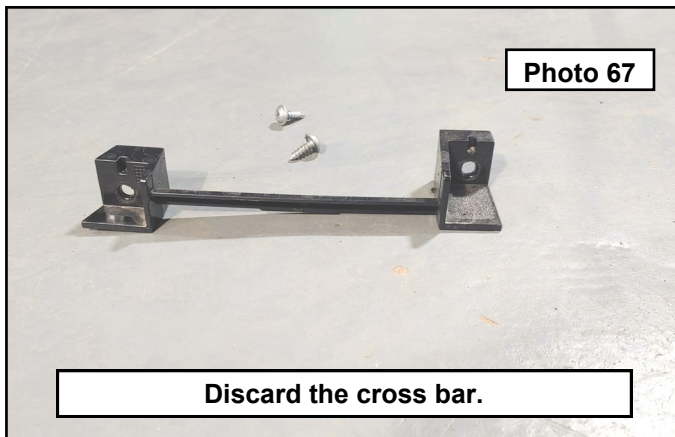

61. Reinstall the air intake and core support cover using the reset rivets. Once in they are put into place, gently push the center in until it is flush to lock them in. **Photo 67 / 68**

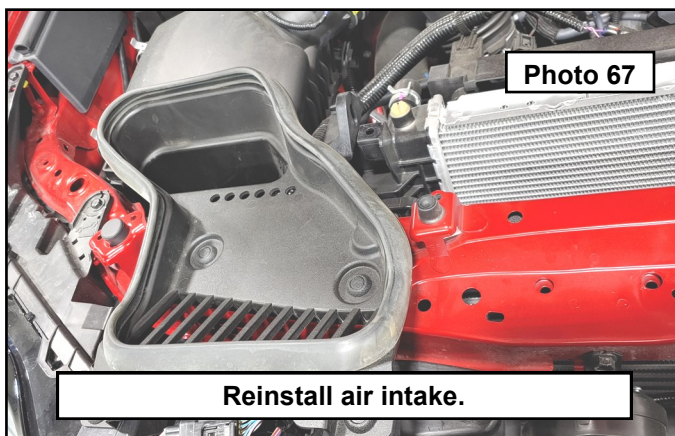

62. Slide the rope through the rubber isolator and attach the hook to the rope eyelet using the provided cotter pin. Test the winch by cycling the rope in and out. The rope is not ready to use out of the box and requires a pre-stretch procedure. If you are not familiar, please look up procedure online and complete before use. Install shackle bracket mounts if you have purchased according to the instructions provided with the kit. **Photo 69 / 70**

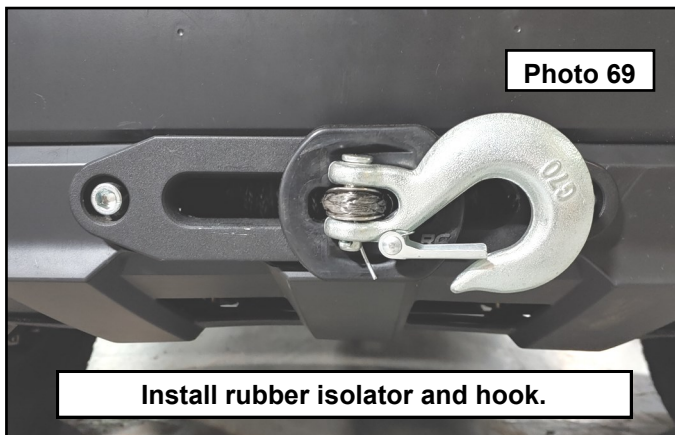

By purchasing any item sold by Rough Country, LLC, the buyer expressly warrants that he/she is in compliance with all applicable , State, and Local laws and regulations regarding the purchase, ownership, and use of the item. It shall be the buyers responsibility to comply with all Federal, State and Local laws governing the sales of any items listed, illustrated or sold. The buyer expressly agrees to indemnify and hold harmless Rough Country, LLC for all claims resulting directly or indirectly from the purchase, ownership, or use of the items.