

# ROUGH COUNTRY

## SUSPENSION SYSTEMS®

### GM 2015-22 COLORADO/CANYON HD2 STEP

Thank you for choosing Rough Country for all your vehicle needs.

Please read instructions before beginning installation. Check the kit hardware against the kit contents shown below. Be sure you have all needed parts and know where they go.

If question exist, please call us @1-800-222-7023. We will be happy to answer any questions concerning this product.

Check all fasteners for proper torque. Check to ensure for adequate clearance between all components.

Periodically check all hardware for tightness.

#### KIT CONTENTS:

Step Rails x2  
Dr. Bracket x3  
Pass. Bracket x3  
Dr. Rear Bracket x1  
Pass. Rear Bracket x1  
Front End Cap x2  
Rear End Cap x2  
Tread Plate x4

#### TOOLS NEEDED:

10mm Wrench or Socket  
13mm Wrench or Socket

#### HARDWARE INCLUDED:

16 - 8mm Clip Nut  
16 - 8mm Lock Washer  
16 - 8mm Oversize Washer  
16 - 8mm x 30mm Bolt  
16 - 6mm x 20mm Bolt  
16 - 6mm Lock Nut  
16 - 6mm Flat Washer  
8 - 6mm x 15mm Button Head Bolt  
8 - 6mm Hex Nut  
24 - 8mm Self Threading Nut



#### Torque Specs:

Size	Grade 5	Grade 8	Size	Class 8.8	Class 10.9
5/16"	15 ft/lbs	20ft/lbs	6MM	5ft/lbs	9ft/lbs
3/8"	30 ft/lbs	35ft/lbs	8MM	18ft/lbs	23ft/lbs
7/16"	45 ft/lbs	60ft/lbs	10MM	32ft/lbs	45ft/lbs
1/2"	65 ft/lbs	90ft/lbs	12MM	55ft/lbs	75ft/lbs
9/16"	95 ft/lbs	130ft/lbs	14MM	85ft/lbs	120ft/lbs
5/8"	135ft/lbs	175ft/lbs	16MM	130ft/lbs	165ft/lbs
3/4"	185ft/lbs	280ft/lbs	18MM	170ft/lbs	240ft/lbs



## HD2 BOARD ASSEMBLY

1. Place molded tread plate onto the running board by aligning the pegs with the holes in the step board. **See Photo 1.**
2. Secure the tread plate to the step board using a 13mm socket. **See Photo 2.**

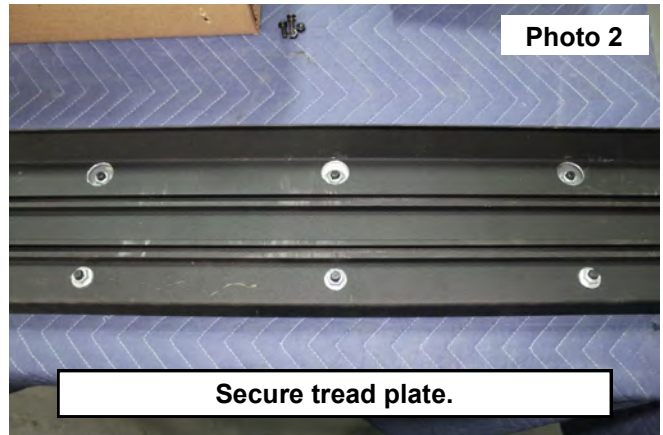

3. Place (2) 6mm nuts into the track on the underside of the step board. **See Photo 3.**
4. Use (2) supplied 6mm lock washers and button head bolts to secure the endcap to the step board. Tighten with a 4mm Allen wrench. **See Photo 4.**

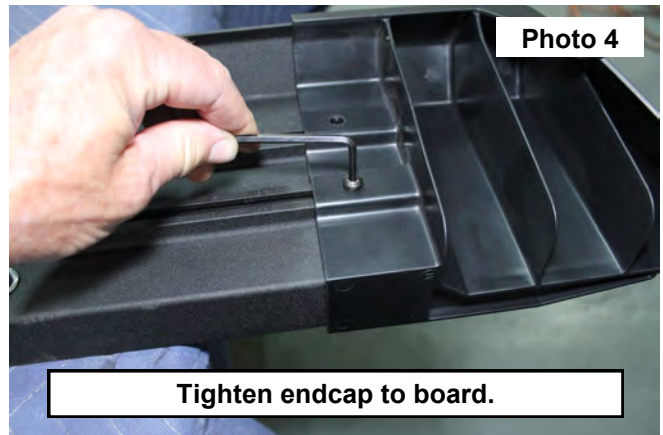
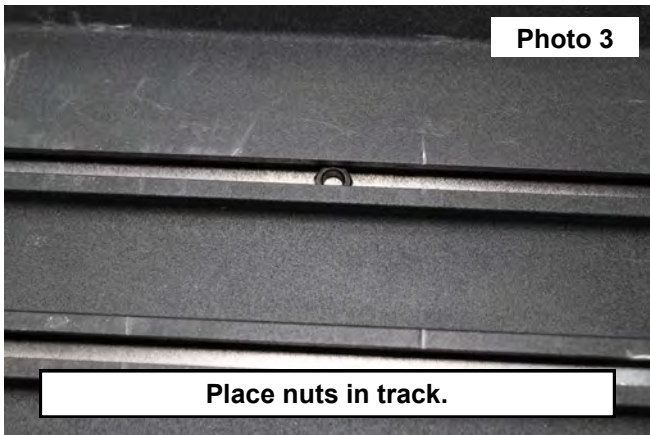

5. Slide (2) 6mm x 18mm bolts into each track on the step board.
6. For each bracket, slide a supplied 6mm x 20mm bolt into each track.
7. Repeat Step 4 to install the other end cap.

## INSTALLATION INSTRUCTIONS

1. Install the supplied 8mm clip nuts into the factory mounting locations in the rocker panel. **See Photo 1.**
2. Hand thread a supplied 8mm bolt, lock washer, and oversize washer into the upper body clip. Hang the step bracket on the protruding bolt. **See Photo 2.**

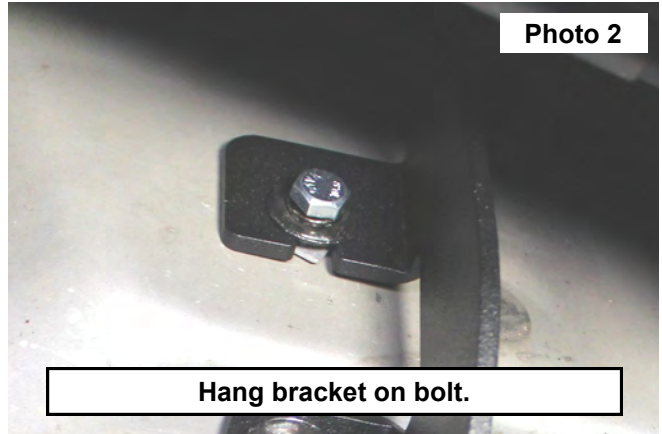

3. Install the supplied 8mm bolt, lock washer, and oversize washer into the lower body clip. Tighten with a 13mm wrench. Fully tighten upper hardware. **See Photo 3.**
4. Repeat for remaining brackets
5. Align the bolts of the assembled board into the slots of the bracket. Secure the boards with the supplied 6mm washers and lock nuts. Tighten with a 10mm wrench. **See Photo 4.**

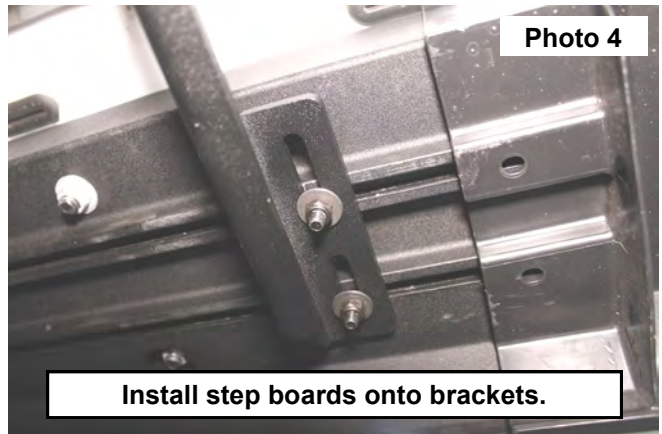
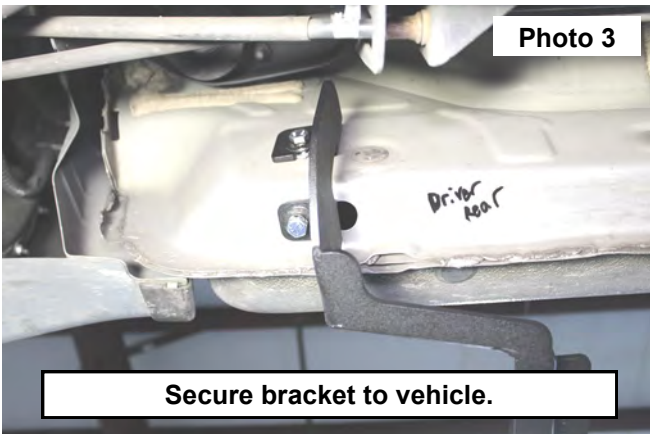

By purchasing any item sold by Rough Country, LLC, the buyer expressly warrants that he/she is in compliance with all applicable, State, and Local laws and regulations regarding the purchase, ownership, and use of the item. It shall be the buyers responsibility to comply with all Federal, State and Local laws governing the sales of any items listed, illustrated or sold. The buyer expressly agrees to indemnify and hold harmless Rough Country, LLC for all claims resulting directly or indirectly from the purchase, ownership, or use of the items.

